

SF-1-11-12 -13

DESCRIPCIÓN TÉCNICA

- Sello simple
- No Equilibrado
- Bi-direccional
- Fuelle de goma

MATERIALES

- **Caras de Roca:**
Carburo de silicio (Q1), Carburo de tungsteno (U), Grafito (B).
- **Estacionario:**
Carburo de silicio (Q1), Carburo de tungsteno (U), Grafito (B).
- **Muelle:**
AiSi 304
- **Sello Secundario:**
NBR, FKM, EPDM

LÍMITES OPERATIVOS

- $d1 = 10 - 100 \text{ mm}$
- $p1 = 1.2 \text{ MPa}$
- $t = -20 - 180 \text{ }^\circ\text{C}$
- $vg = 10 \text{ m/s}$

SECTORES:



SF-1

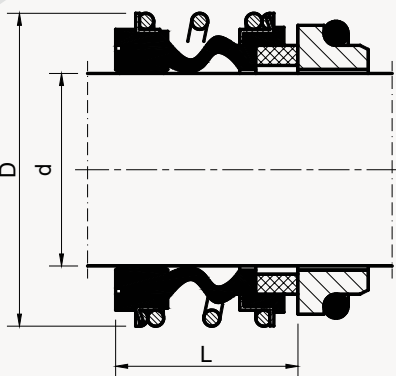

SF-12

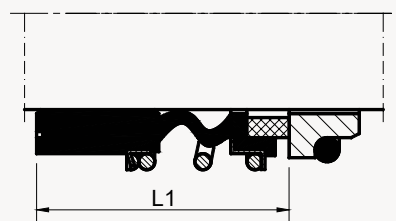

SF-13

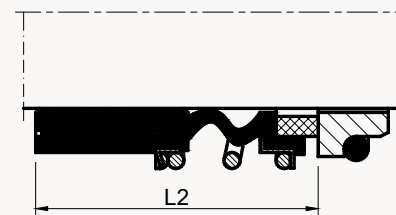

Dimensiones

d	D	L	L1	L2
10	22.5	14.5	25.9	33.4
12	25.0	15.0	25.9	33.4
14	28.5	17.0	28.4	33.4
15	28.5	17.0	28.4	33.4
16	28.5	17.0	28.4	33.4
18	32.0	19.5	30.0	37.5
20	37.0	21.5	30.0	37.5
22	37.0	21.5	30.0	37.5
24	42.5	22.5	32.5	42.5
25	42.5	23.0	32.5	42.5
28	49.0	26.5	35.0	42.5
30	49.0	26.5	35.0	42.5
32	53.5	27.5	35.0	47.5
33	53.5	27.5	35.0	47.5
35	57.0	28.5	35.0	47.5
38	59.0	30.0	36.0	46.0
40	62.0	30.0	36.0	46.0

d	D	L	L1	L2
42	65.5	30.0	36.0	51.0
43	65.5	30.0	36.0	51.0
45	68.0	30.0	36.0	51.0
48	70.5	30.5	36.0	51.0
50	74.0	30.5	36.0	50.5
53	78.5	33.0	36.5	59.0
55	81.0	35.0	36.5	59.0
58	85.5	37.0	41.5	59.0
60	88.5	38.0	41.5	59.0
65	93.5	40.0	41.5	69.0
68	96.5	40.0	41.5	68.7
70	99.5	40.0	48.7	68.7
75	107.0	40.0	48.7	68.7
80	112.0	40.0	48.0	78.0
85	120.0	41.0	46.0	76.0
90	127.0	45.0	51.0	76.0
95	132.0	46.0	51.0	76.0

Dimensiones en Milímetros