

SF-2 DIN



DESCRIPCIÓN TÉCNICA

- Sello simple
- No Equilibrado
- Unimuelle
- Bi-direccional
- Fuelle de goma

MATERIALES

- **Caras de Roce:**
Carburo de silicio (Q1), Carburo de tungsteno (U), Grafito (B), Cerámica (V).
- **Estacionario:**
Carburo de silicio (Q1), Carburo de tungsteno (U), Grafito (B), Cerámica (V).
- **Fuelle:**
NBR, FKM, EPDM.
- **Muelle:**
AiSi 304
- **Partes metálicas:**
AiSi 316, AiSi 304
- **Sello Secundario:**
NBR, FKM, EPDM.

LÍMITES OPERATIVOS

- $d1 = 10 - 100 \text{ mm}$
- $p1 = 1.0 \text{ MPa}$
- $t = -40 - 205 \text{ °C}$
- $vg = 10 \text{ m/s}$

SECTORES:

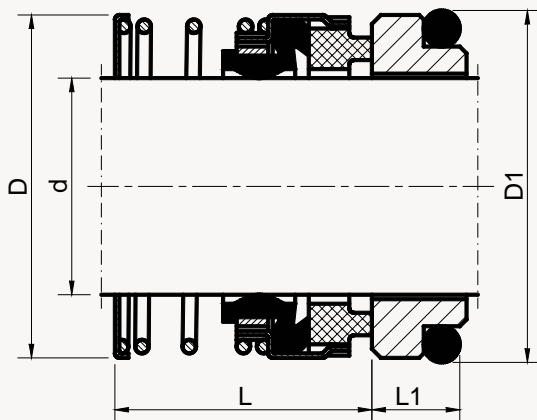

Dimensiones

d	D	D1	L	L1
10	20.0	21.0	23.9	8.6
12	22.0	23.0	23.9	8.6
14	26.5	25.0	26.4	8.6
16	28.0	27.0	26.4	8.6
18	29.5	33.0	27.5	10.0
20	31.6	35.0	27.5	10.0
22	31.6	37.0	27.5	10.0

d	D	D1	L	L1
24	40.0	39.0	30.0	10.0
25	40.0	40.0	30.0	10.0
28	42.5	43.0	32.5	10.0
30	45.0	45.0	32.5	10.0
32	47.5	48.0	32.5	10.0
33	47.5	48.0	32.5	10.0
35	50.0	50.0	32.5	10.0
38	54.5	56.0	34.0	11.0
40	57.0	58.0	34.0	11.0
43	60.5	61.0	34.0	11.0
45	63.0	63.0	34.0	11.0
48	64.0	66.0	34.0	11.0
50	67.8	70.0	34.5	13.0
53	71.0	73.0	34.5	13.0
55	74.0	75.0	34.5	13.0
58	80.0	78.0	39.5	13.0
60	82.5	80.0	39.5	13.0
63	82.5	83.0	39.5	13.0
65	85.0	85.0	39.5	13.0
68	85.0	90.0	37.2	15.3
70	92.0	92.0	44.7	15.3
75	100.0	97.0	44.7	15.3
80	105.0	105.0	44.3	15.7
85	110.0	110.0	44.3	15.7
90	115.0	115.0	49.3	15.7
95	119.0	120.0	49.3	15.7
100	124.0	125.0	49.3	15.7